

# 1stVision Inc.

## PRECISION MACHINE VISION LENS

### LE-MV3-1218

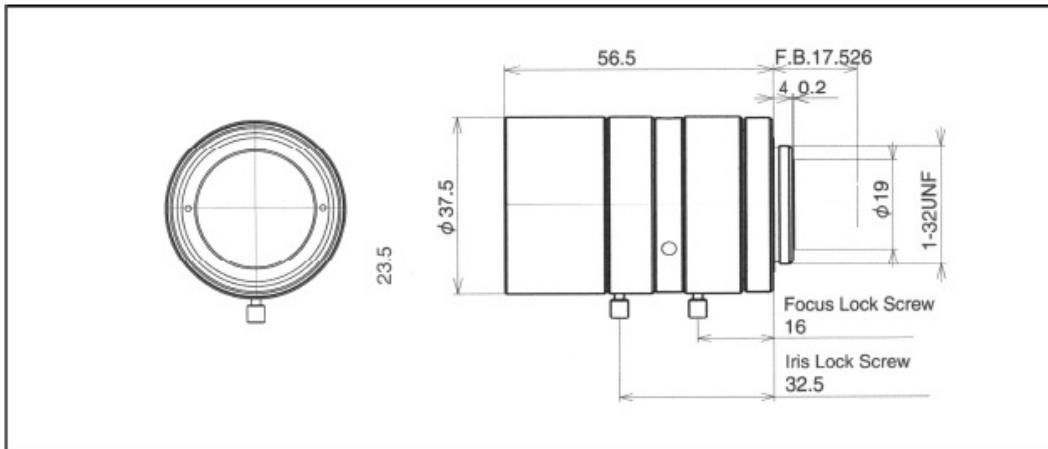

<b>Image Format:</b>	2/3-inch
<b>Focal Length:</b>	12mm
<b>Relative Aperture:</b>	F = 1: 1.8
<b>Iris Range:</b>	1.8 - close
<b>Angular Field of View:</b>	<b>Horizontal:</b> 40.3°
	<b>Vertical:</b> 30.8°
<b>Resolution:</b>	<b>Center :</b> 160 lp/mm or more
	<b>Corner :</b> 125 lp/mm or more
<b>Distortion:</b>	<b>on 2/3" sensor :</b> -0.22%(0.15m)
<b>MOD (Minimum Object Distance):</b>	0.15m
<b>Back Focus:</b>	14.04mm in air
<b>Flange Back:</b>	17.526mm
<b>Operation:</b>	<b>Focus:</b> Manual with lock screw
	<b>Iris:</b> Manual with lock screw
<b>Lens Mount:</b>	C-Mount Type
<b>Filter Screw:</b>	35.5mm, P = 0.5
<b>Dimensions:</b>	φ37.5 x 56.5mm
<b>Weight:</b>	
<b>Operating Temperature:</b>	-10 ~ +50°C

Note : Angular field of view(H x V) is captured on the 2/3-inch image sensor at MOD.