

# 1stVision Inc.

## PRECISION MACHINE VISION LENS

LE-MV2-814

2 Mega-pixel

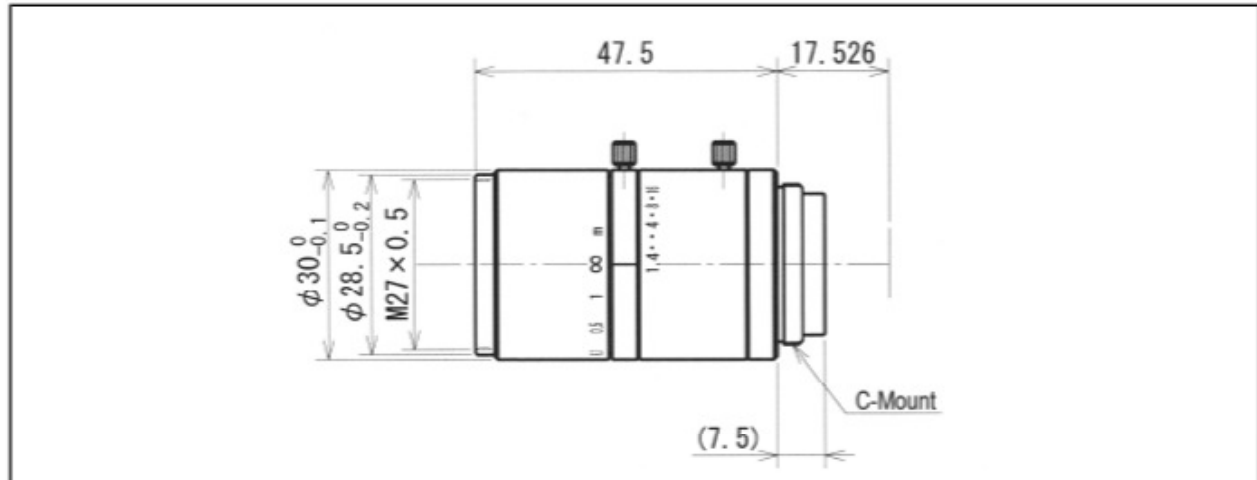

<b>Image Format:</b>	2/3-inch
<b>Focal Length:</b>	8mm
<b>Relative Aperture:</b>	F = 1: 1.4
<b>Iris Range:</b>	1.4 - 16
<b>Angular Field of View:</b>	<b>Horizontal:</b> 57.32° <b>Vertical:</b> 44.29° <b>Diagonal:</b> 68.66°
<b>Minimum Object Distance(MOD):</b>	0.1m
<b>View Area at Minimum Distance:</b>	
<b>Back Focus:</b>	11.14mm
<b>Flange Back:</b>	17.526mm
<b>Operation:</b>	<b>Focus:</b> Manual with lock screw <b>Iris:</b> Manual with lock screw
<b>Lens Mount:</b>	C-Mount Type
<b>Filter Screw:</b>	M27, P = 0.5
<b>Dimensions:</b>	φ30 x 47.5mm
<b>Weight:</b>	100g approx.
<b>TV Distortion:</b>	<b>On 2/3" CCD:</b> -0.39%
<b>Resolution:</b>	<b>On 2/3" CCD:</b> 140 / 80 lp/mm <b>On 1/2" CCD:</b> 140 / 140 lp/mm

Made in Japan