

THIS DOCUMENT AND THE INFORMATION IT CONTAINS ARE PROPERTY OF EFFILUX AND CONFIDENTIAL. THEY SHALL NOT BE REPRODUCED NOR DISCLOSED TO ANY PERSON EXCEPT TO THOSE HAVING A NEED TO KNOW THEM WITHOUT PRIOR WRITTEN CONSENT OF EFFILUX

CE DOCUMENT ET LES INFORMATIONS QU'IL CONTIENT SONT CONFIDENTIELS ET SONT LA PROPRIETE EXCLUSIVE DE EFFILUX. ILS NE DOIVENT ETRE COMMUNIQUEES QU'AUX PERSONNES AYANT A EN CONNAITRE ET NE PEUVENT ETRE REPRODUITS NI DIVULGUES A TOUTE AUTRE PERSONNE SANS AUTORISATION PREALABLE ECRITE PAR EFFILUX

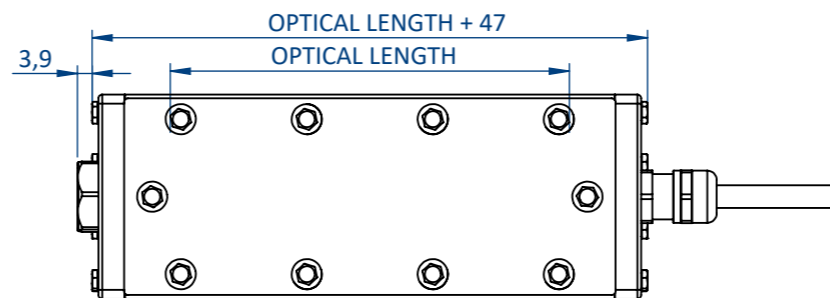

NUMBER OF LED-XXX (STANDARD VERSION)	OPTICAL LENGTH	PRODUCT LENGTH	WEIGHT (KG)
5 LED	100	147	0,8
10 LED	200	247	1,2
15 LED	300	347	1,5
20 LED	400	447	1,9
25 LED	500	547	2,3
30 LED	600	647	2,7
...

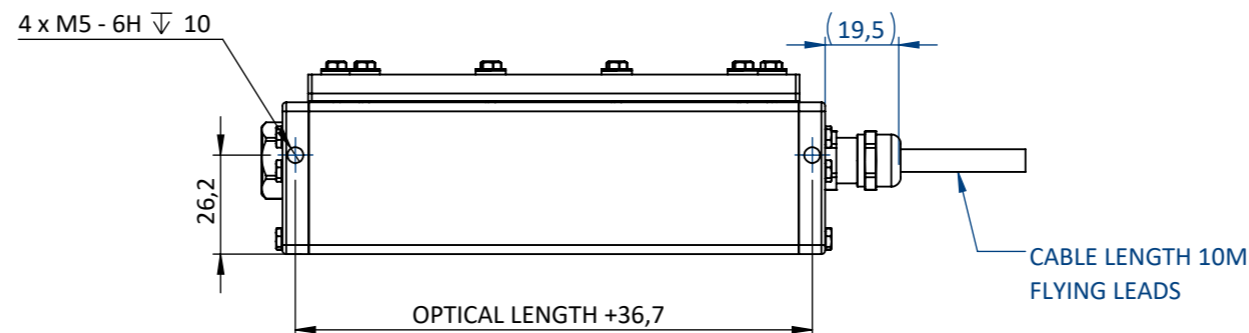
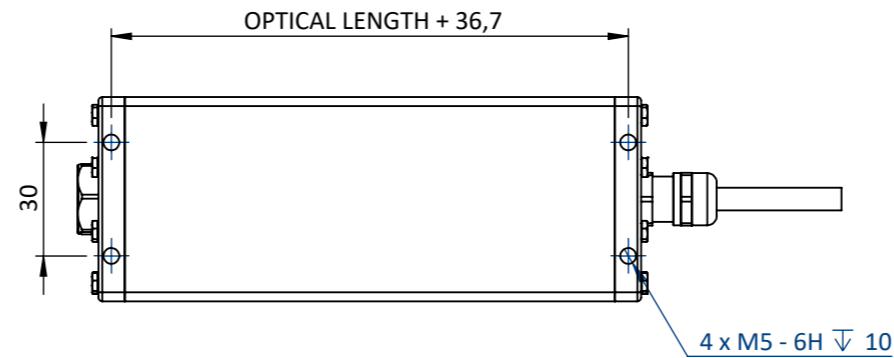
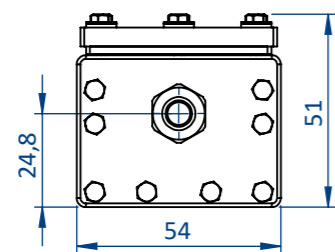
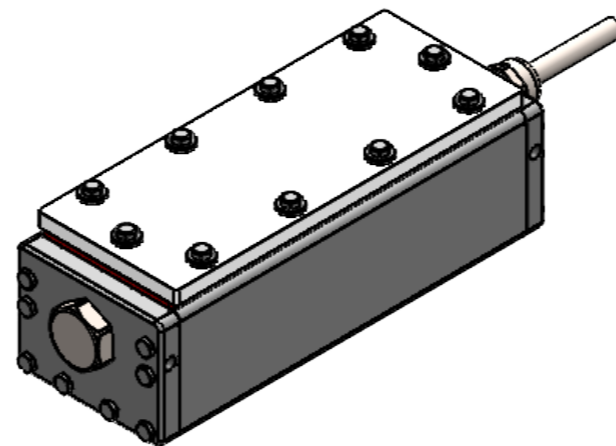

STANDAR EFFI-FLEX-IP69K IS DELIVERED WITH X8 M5X8 SCREWS TO AVOID WATER RETENTION. THESE SCREWS CAN BE REMOVED TO INSTALL THE PRODUCT THANKS TO THE THREADED HOLES

PLEASE REFER TO THE SPECIFIC DOCUMENTATION FOR WIRING LAYOUT

Reference EFFI-FLEX-IP69K		IP 69K	1 Rue de Terre Neuve Mini Parc du Verger Bâtiment E 91940 Les Ulis, France	
Designation EFFI-FLEX-IP69K-XXX-ZZZ-WW-PP-V			Mail: sales@effilux.fr Tel : +33 9 72 52 70 03 www.effilux.com	
Revision /	Date 29/05/2020	Unit : mm	General Tolerances	
Scale 1:2	Size A3	Page 1/2	ISO 2768 - fH-E	

THIS DOCUMENT AND THE INFORMATION IT CONTAINS ARE PROPERTY OF EFFILUX AND CONFIDENTIAL. THEY SHALL NOT BE REPRODUCED NOR DISCLOSED TO ANY PERSON EXCEPT TO THOSE HAVING A NEED TO KNOW THEM WITHOUT PRIOR WRITTEN CONSENT OF EFFILUX

CE DOCUMENT ET LES INFORMATIONS QU'IL CONTIENT SONT CONFIDENTIELS ET SONT LA PROPRIETE EXCLUSIVE DE EFFILUX. ILS NE DOIVENT ETRE COMMUNIQUEES QU' AUX PERSONNES AYANT A EN CONNAITRE ET NE PEUVENT ETRE REPRODUITS NI DIVULGUES A TOUTE AUTRE PERSONNE SANS AUTORISATION PREALABLE ECRITE PAR EFFILUX

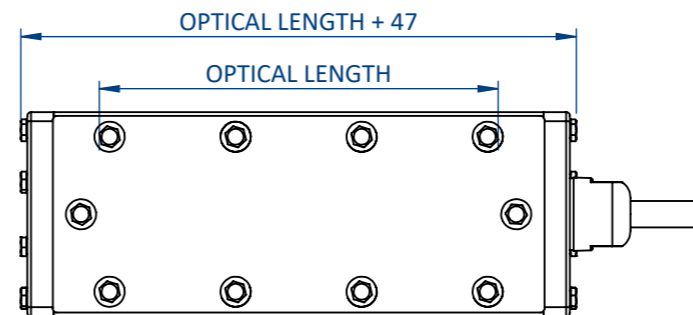
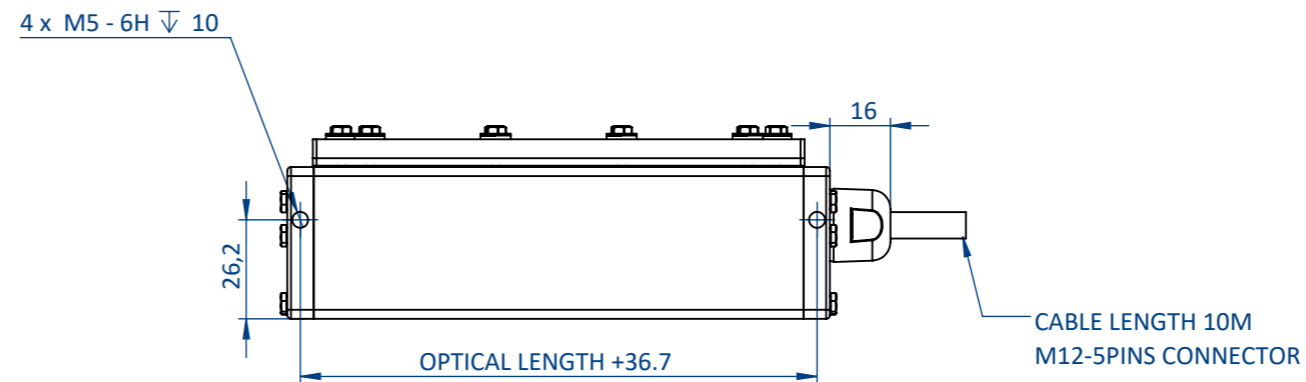
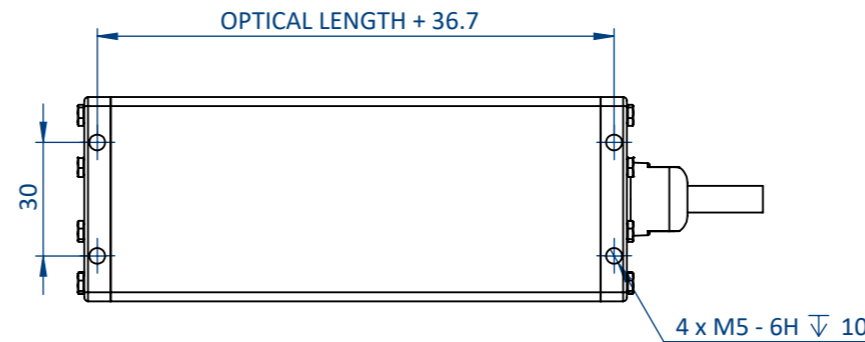
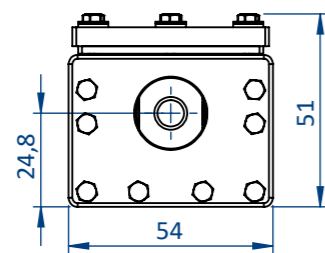

NUMBER OF LED-XXX (STANDARD VERSION)	OPTICAL LENGTH	PRODUCT LENGTH	WEIGHT (KG)
5 LED	100	147	0,8
10 LED	200	247	1,2
15 LED	300	347	1,5
20 LED	400	447	1,9
25 LED	500	547	2,3
30 LED	600	647	2,7
35 LED	700	747	3,1
40 LED	800	847	3,5
45 LED	900	947	3,9

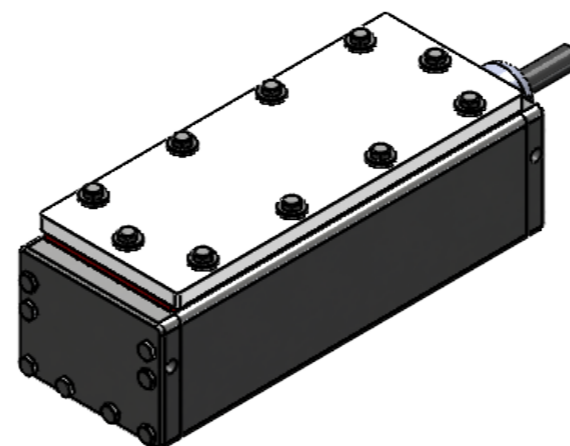

STANDAR EFFI-FLEX-IP69K-FOOD IS DELIVERED WITH X8 M5X8 SCREWS TO AVOID WATER RETENTION. THESE SCREWS CAN BE REMOVED TO INSTALL THE PRODUCT THANKS TO THE THREADED HOLES

PLEASE REFER TO THE SPECIFIC DOCUMENTATION FOR WIRING LAYOUT

Reference	IP	1 Rue de Terre Neuve Mini Parc du Verger Bâtiment E 91940 Les Ulis, France
EFFI-FLEX-IP69K-FOOD		69K
Designation		Mail: sales@effilux.fr Tel : +33 9 72 52 70 03 www.effilux.com
EFFI-FLEX-IP69K-FOOD-XXX-ZZZ-WW-PP		
Revision /	Date 28/07/2020	Unit : mm
Scale 1:2	Size A3	Page 2/2
General Tolerances ISO 2768 - fH-E		