

Rev No.	Description	Date	Name
A	First light	10/03/06	A.Vismara
B	Length of C thread	12/01/09	A.Vismara

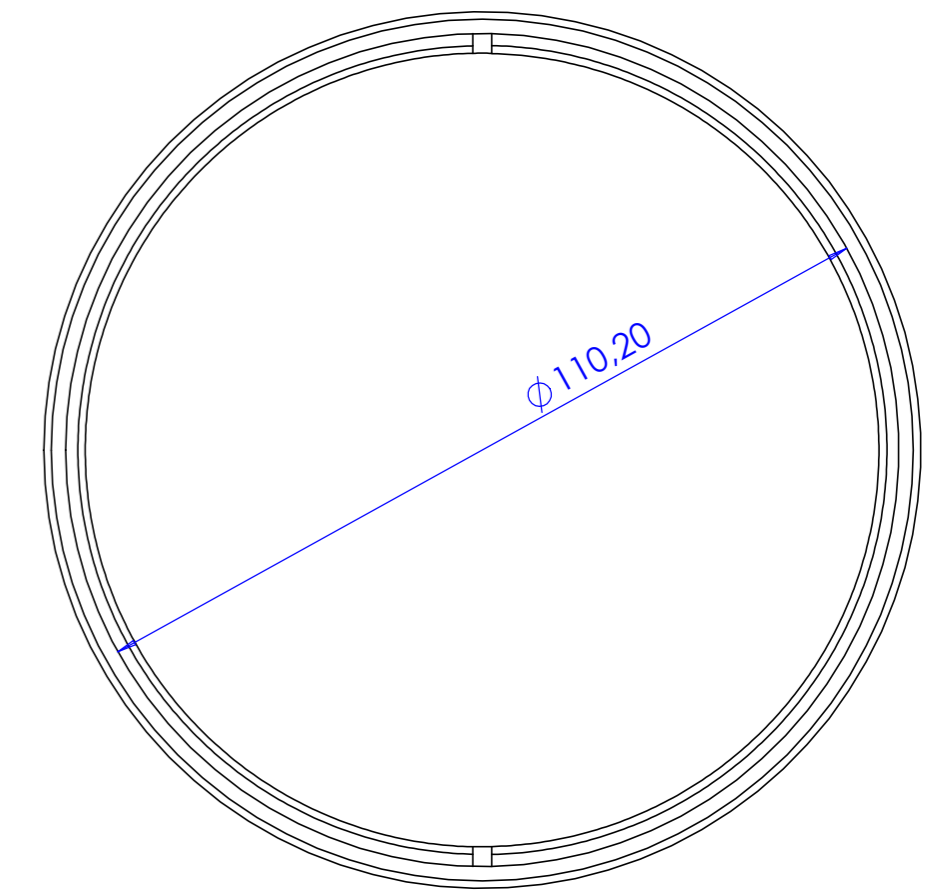
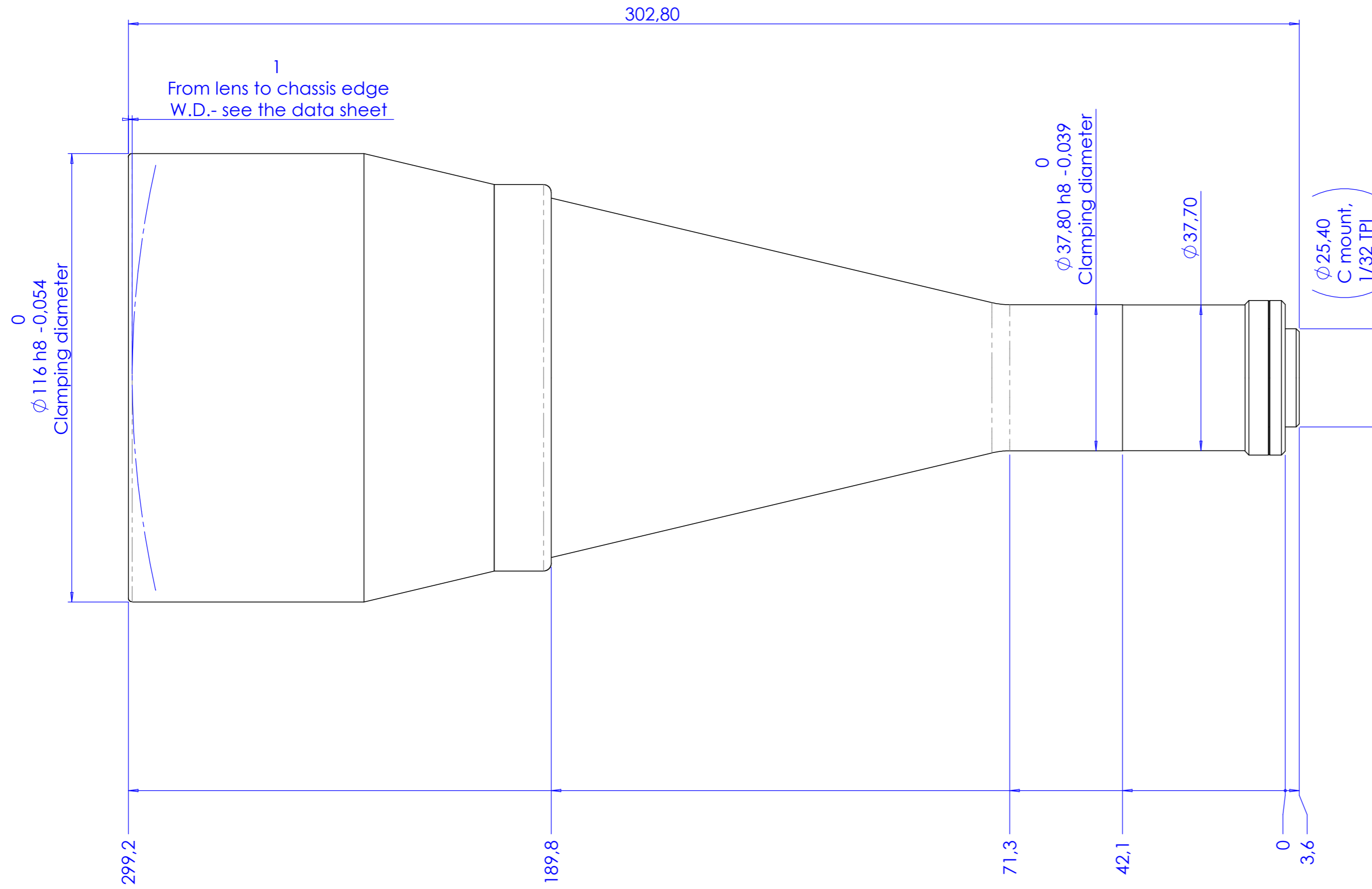

Material	N.A.	Mass	1,6 kg	Scale	1:1
Surface treatment	N.A.	Project-Prod.Item/Instrument Telecentric lens 23 72			
Geometrical tolerance (ISO 2768-2)		Class	K	Undimensioned bevels	1x45°
0.5	>3±	>6±	>30±	>120	>400±
+3	6	30	120	+400	+1000
±0,1	±0,1	±0,2	±0,3	±0,5	±0,8
				±1,2	±2
				±2	
Undimensioned radii		R 0,5		Description Assembly	
Date		Name		Drawing No.	
Designed 10/03/06		A.Vismara		02451-0-B	
Draw 12/01/09		A.Vismara		Sheet 1/1	
Checked X		C.Sedazzari		Reproduction forbidden without specific authorization	
OPTO ENGINEERING S.r.l. - 46100 Mantova Italy - Via Cremona, 28 - Tel/fax +39 0376 263525 - e-mail: info@opto-engineering.com - http://www.opto-engineering.com					