



10 GIGAVISION **GEN*i*CAM**



sensor information

| | |
|---------------|--------------------|
| sensor | Sony IMX252 |
| resolution | 2048 × 1536 px |
| exposure time | 0,001 ... 60000 ms |
| pixel size | 3.45 × 3.45 μm |
| shutter type | Global shutter |
| sensor type | 1/1.8" CMOS |

acquisition formats

| | |
|------------------------------|---|
| image formats, interface | Full Frame, 2048 × 1536 px, max. 215 fps |
| frame rate max. | Binning 2×2, 1024 × 768 px, max. 215 fps Binning 2×1, 1024 × 1536 px, max. 215 fps Binning 1×2, 2048 × 768 px, max. 215 fps |
| image formats, acquisition | Full Frame, 2048 × 1536 px, max. 215 fps |
| frame rate max. (Burst Mode) | |
| pixel formats | BayerRG8 BayerRG10 BayerRG12 BayerRG12 Packed Mono8 Mono10 Mono12 Mono12 Packed RGB8 BGR8 |

image preprocessing

| | |
|-----------------|---|
| analog controls | Gain (0 ... 48 dB) Offset (0 ... 255 LSB 12 Bit) |
| color models | Mono Raw Bayer RGB BGR |

interfaces and connectors

| | |
|-------------------|--|
| data interface | 10 Gigabit Ethernet, Transfer rate 10000 Mbits/sec, Gigabit Ethernet, Transfer rate 1000 Mbits/sec, Fast Ethernet, Transfer rate 100 Mbits/sec, Connector: M12 / 8-pol x-coded (SACC-CI-M12FS-8CON-L180-10G) |
| process interface | M12 / 12 pins a-coded (SACC-CI-M12MS-12CON-L180) |
| power supply | via M12/12 pins a-coded |

mechanical data

| | |
|------------|----------|
| lens mount | C-mount |
| width | 60 mm |
| height | 60 mm |
| depth | 99,7 mm |
| weight | ≤ 485 g |
| material | aluminum |

electrical data

| | |
|-------------------|--|
| voltage supply | 12 ... 24 V DC (external power supply) |
| range +Vs | |
| power consumption | approx. 10,3 W @ 12 VDC and 215 fps |

non-volatile memory

| | |
|-------------------|--------|
| flash memory size | 128 kB |
|-------------------|--------|

environmental conditions

| | |
|-----------------------|--|
| operating temperature | 0 ... +65 ° @ T = measurement point |
| humidity | 10 ... 90 % (non-condensing) |
| protection class | IP 40 IP 54 (with mounted tube and cable) IP 65 (with mounted tube and cable) IP 67 (with mounted tube and cable) |

digital I/Os

| | |
|-------|---|
| lines | 2 input lines 4 output lines with pulse width modulation (PWM) (max. 48 V / max. 2,5 A) RS232 |
|-------|---|

VLXT-31C.I

Gigabit Ethernet, 3,1 Megapixel, Color

Article number: 11194257

conformity

conformity CE
RoHS

dimension drawing

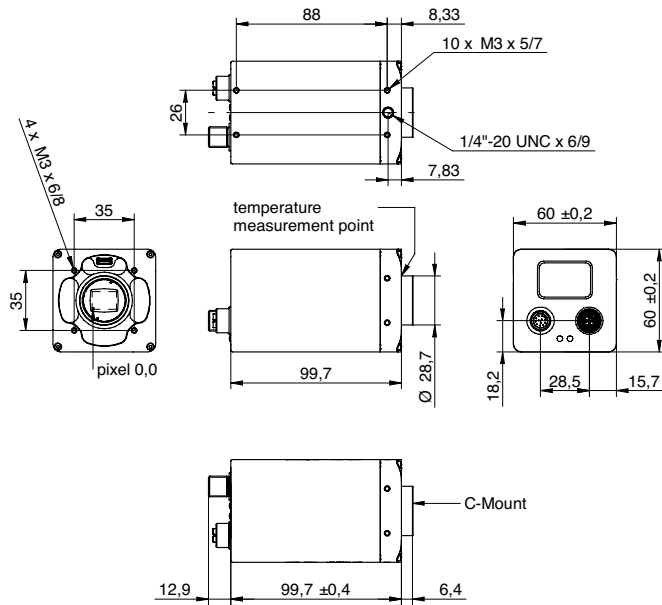

schematic diagram

Optional accessories for protection class IP65/67:

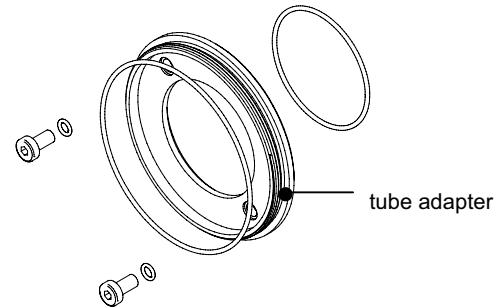

tube adapter

- Ø 49,5 mm, hard-anodized, incl. sealing and screws (VCXG.I 11185373)
- Ø 65 mm, hard-anodized, incl. sealing and screws (VCXG.I 11185377; VLXT 11193125)

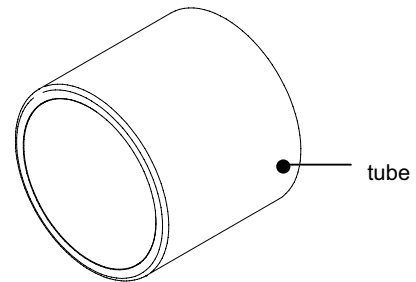

tube

- Ø 49,5 mm, length 44 mm, hard-anodized, cover glass PMMA (11185370)
- Ø 65 mm, length 58 mm, hard-anodized, cover glass PMMA (11185374)
- Ø 49,5 mm, length 44 mm, hard-anodized, tempered laminated safety glass (11195425)
- Ø 65 mm, length 58 mm, hard-anodized, tempered laminated safety glass (11195426)

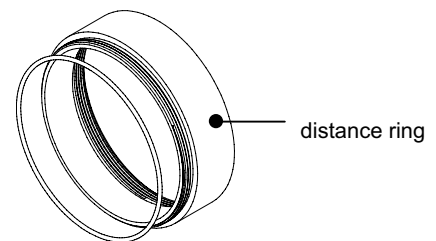

distance ring

- Ø 49,5 mm, length 12 mm, hard-anodized, incl. sealing (11185371)
- Ø 49,5 mm, length 6 mm, hard-anodized, incl. sealing (11185372)
- Ø 65 mm, length 12 mm, hard-anodized, incl. sealing (11185375)
- Ø 65 mm, length 6 mm, hard-anodized, incl. sealing (11185376)
- Ø 65 mm, length 36 mm, hard-anodized, incl. sealing (111988906)