

# RL113

## High Brightness LED Bright Field Ring Light

**Aii** High intensity from a long working distance

**Aii** IP65 compliant design

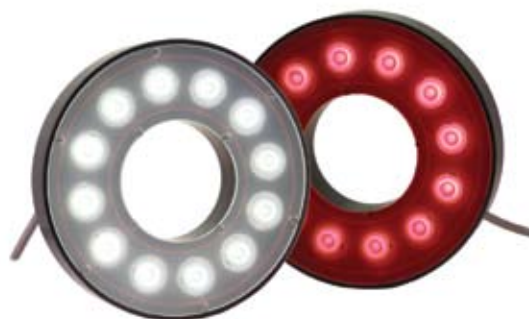

### Ordering Information

Standard Product:  
Shipped Next Day

Standard Product Variation:  
Shipped Within Two Weeks

#### RL113-WHIIC

Configured with in-line  
current source

	Spectral wavelength	Optional power compatibility
RL113 -	XXX	XX
	(blue) 470	IC
	(green) 530	C2
	(red) 625	C3
	(IR) 850	
	(white) WHI	

**Optimal working distance:**  
300mm (12")  
**Effective Working Range:**  
225mm - 600mm (9" - 24")

IC = ICS (requires 24v power supply)  
C2 = Ai Connector  
C3 = Pulsar Connector

### Intensity Distribution

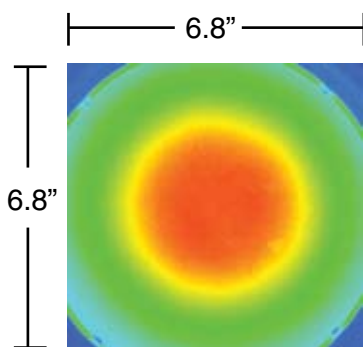

Working Distance: 300mm (12")

## Dimensional Information

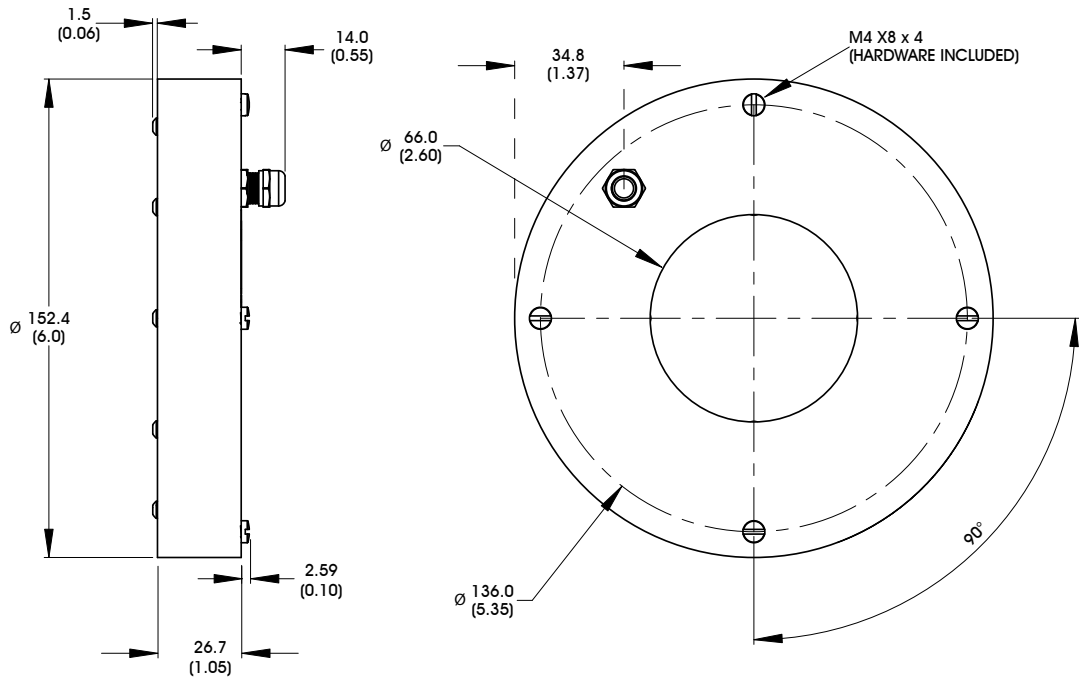

Cable Length: 2 Meters (78")

DIMENSIONS ARE IN MILLIMETERS (INCHES)

### Standard Variation Current Specifications

	blue	green	red	infra-red	white	
Ai / iCS	700	700	700	700	700	mA

### General Specifications

Weight:	680.4 g (1.5 lb)
Finish:	Black Anodized
Operating Temperature:	0-60°C
Meets Specifications:	CE, RoHS

### Standard Product Information

Red	Max. Illumination	Irradiance (mW/cm <sup>2</sup> )	Illuminance (Lux)
	Working Distance: 300mm (12")	2.6	5,200
	Lifetime	50,000 hrs	
White	Max. Illumination	Irradiance (mW/cm <sup>2</sup> )	Illuminance (Lux)
	Working Distance: 300mm (12")	3.5	14,500
	Lifetime	50,000 hrs	

### Additional Information

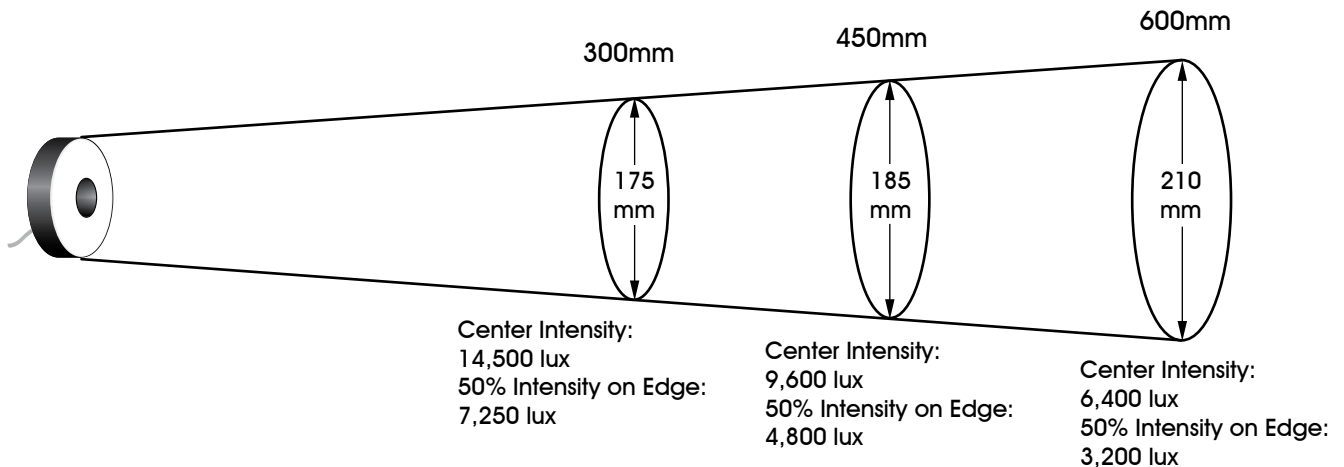

8 0 2 . 7 6 7 . 3 8 3 0