

CLAMPING MECHANISMS FOR TELECENTRIC LENSES

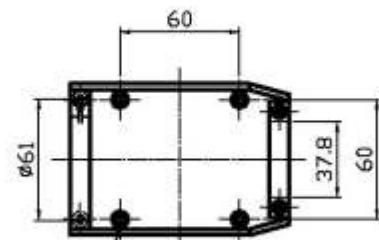

WWW.OPTO-ENGINEERING.COM

TELECLAMP 36

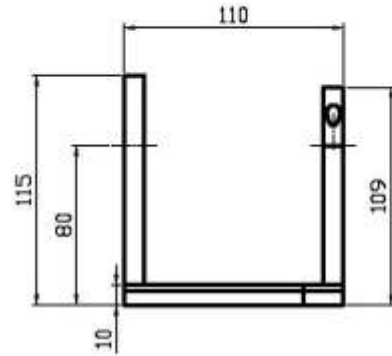
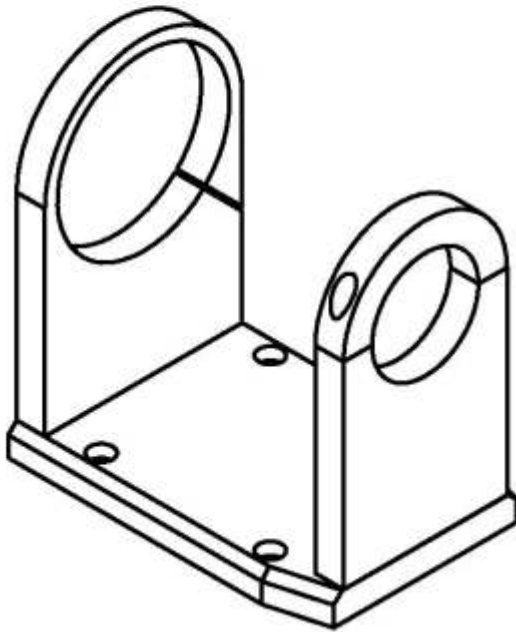

Counter Bore DIN74-Km4

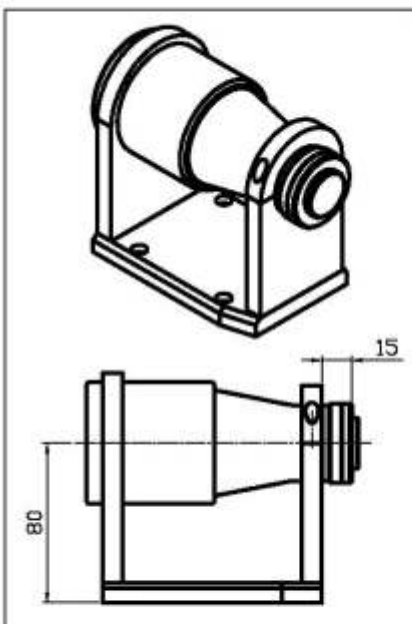

Teleclamp 36
with TC 13 36

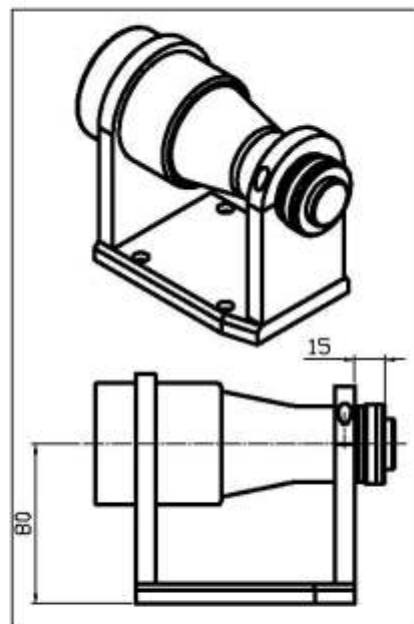

Teleclamp 36
with TC 12 36

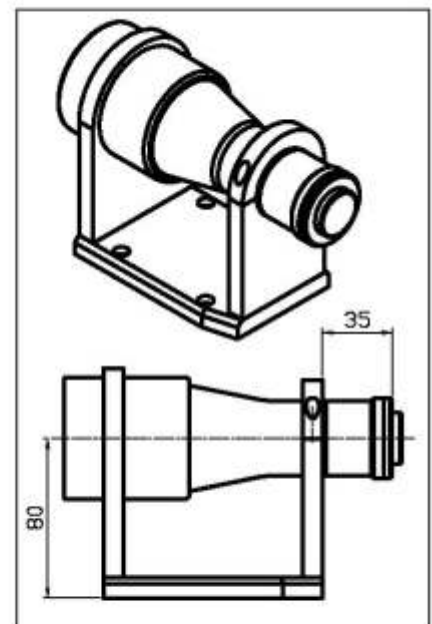

Teleclamp 36
with TC 23 36

CLAMPING MECHANISMS FOR TELECENTRIC LENSES



WWW.OPTO-ENGINEERING.COM

TELECLAMP 56

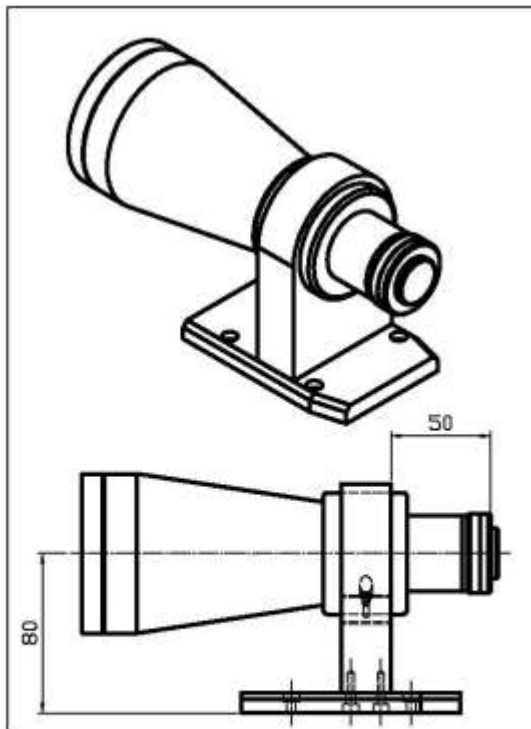
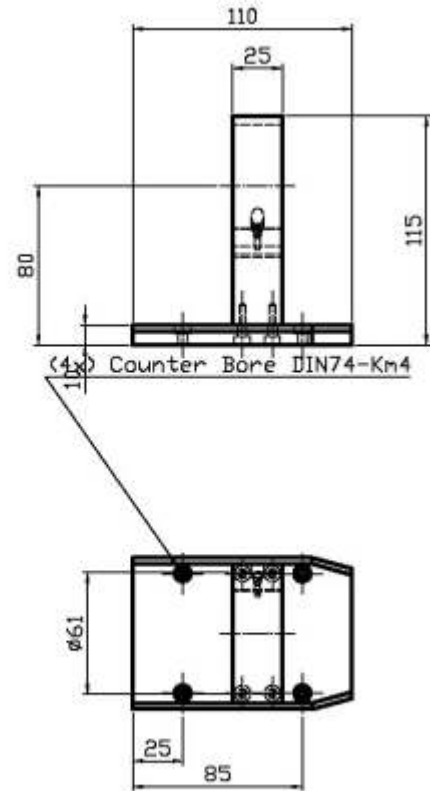
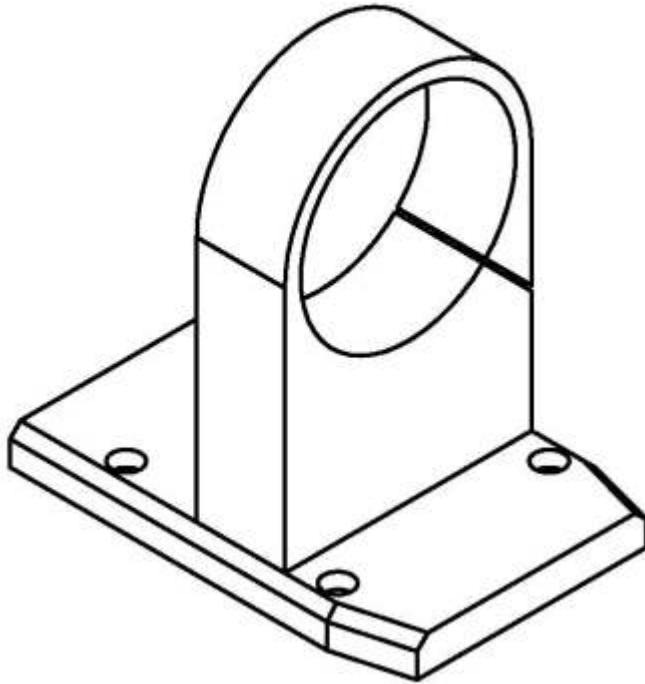

Teleclamp 56
with TC 12 56

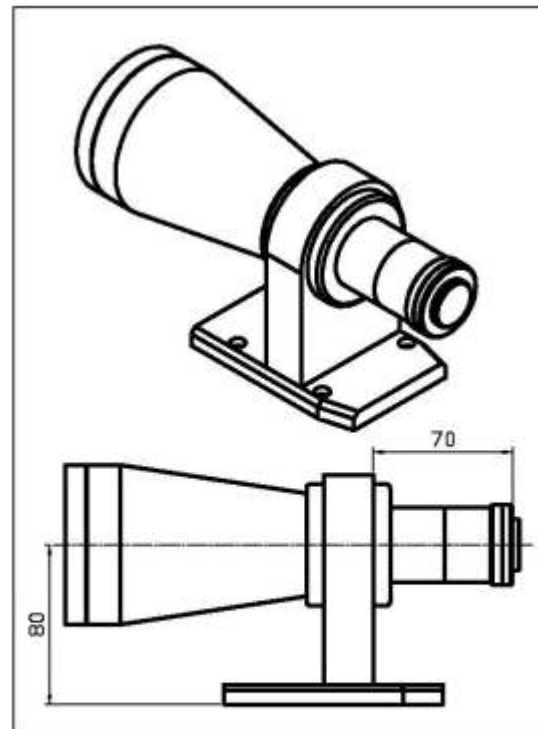

Teleclamp 56
with TC 23 56

CLAMPING MECHANISMS FOR TELECENTRIC LENSES



WWW.OPTO-ENGINEERING.COM

TELECLAMP 64

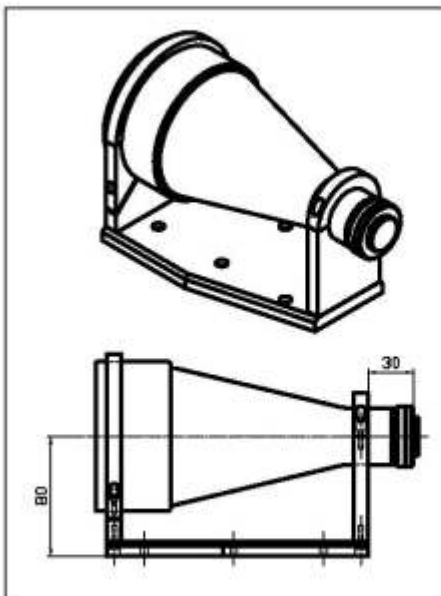
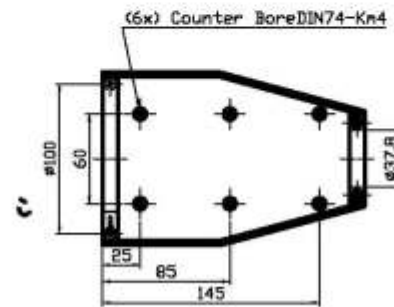
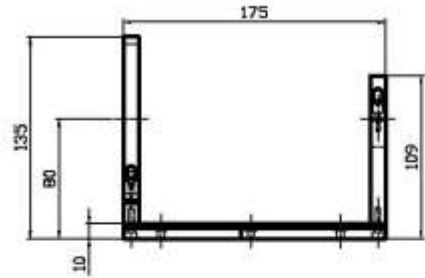
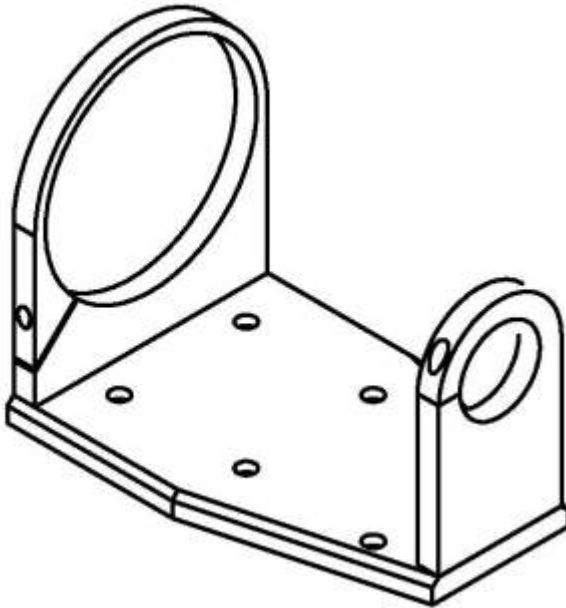

Teleclamp 64
with TC 13 64

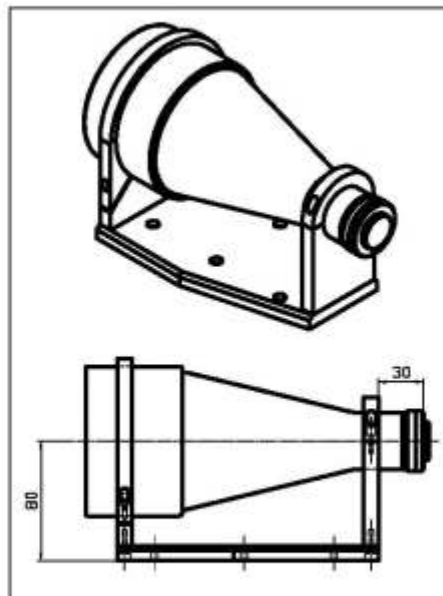

Teleclamp 64
with TC 12 64

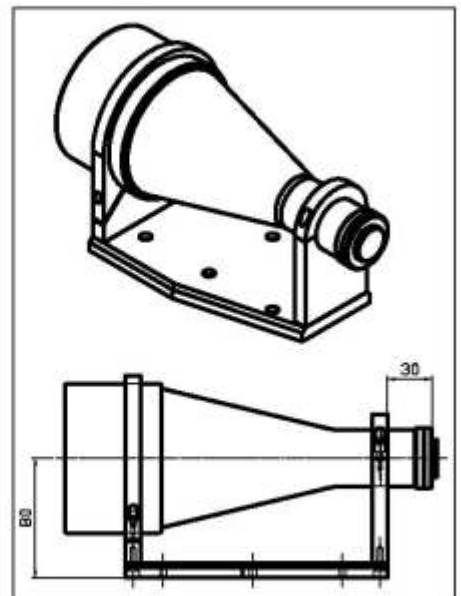

Teleclamp 64
with TC 23 64



TELECLAMP 80

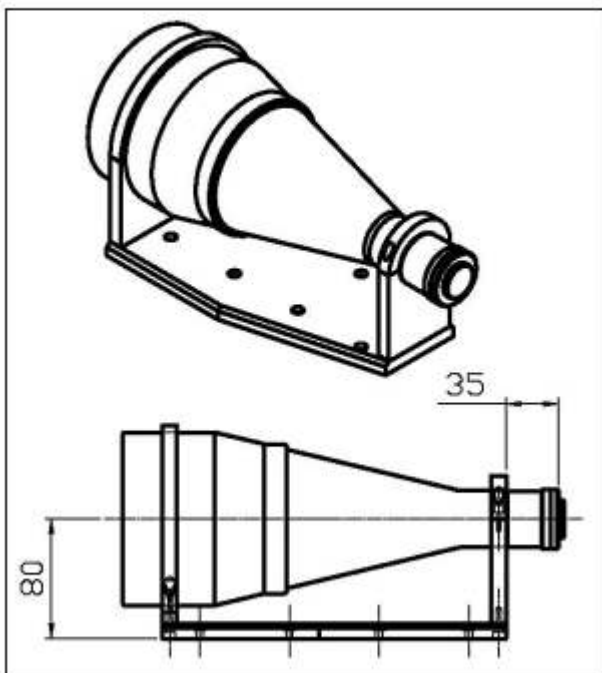
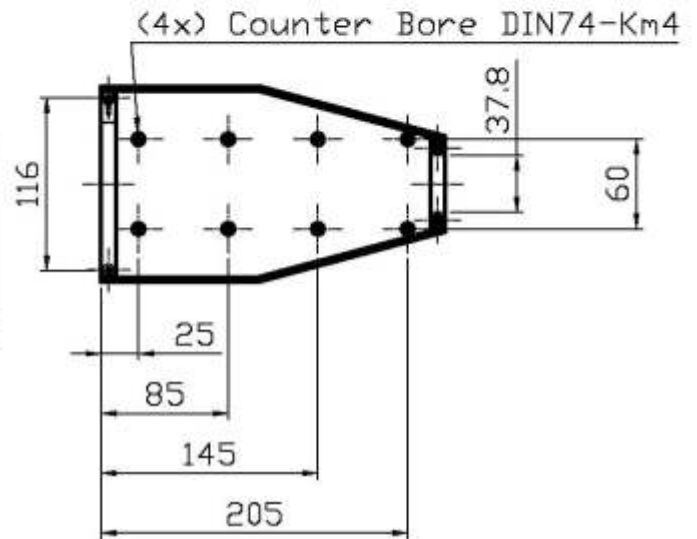
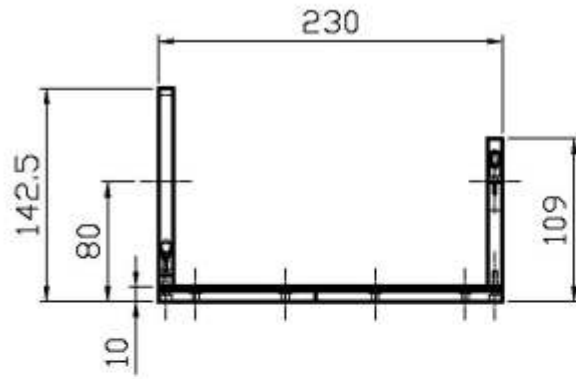
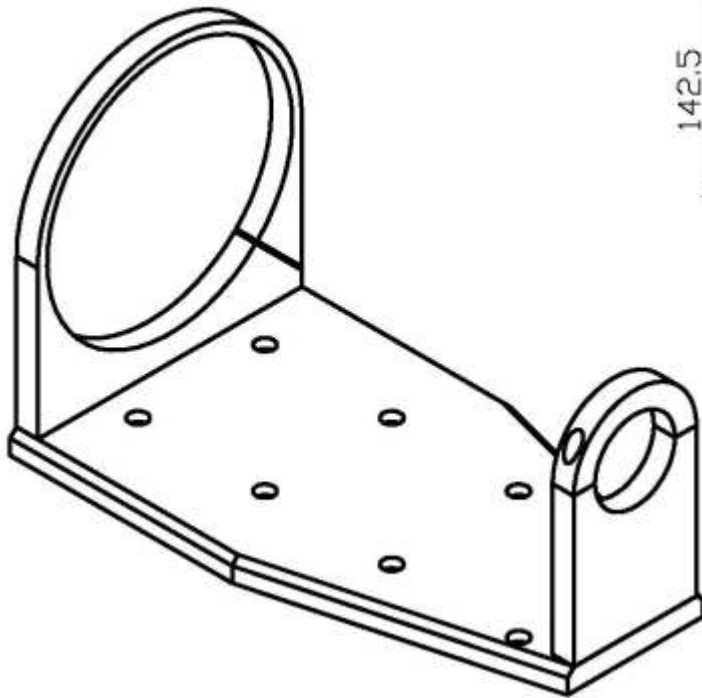

Teleclamp 80 with TC 12 80

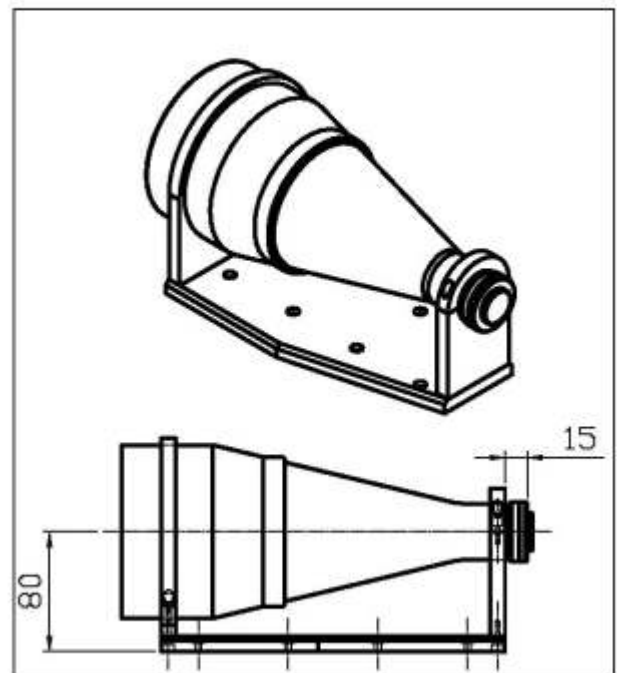

Teleclamp 80 with TC 23 80