

# BI-TELECENTRIC LENS FOR 2/3" TO 1/4" DETECTORS



WWW.OPTO-ENGINEERING.COM



<b>Model:</b>	<b>TC 23 96</b>	
<b>Magnification (X):</b>	0,09	
<b>Object Field (mm):</b>	1/4" (3,6 x 2,7):	39,27 x 29,45
	1/3" (4,8 x 3,6):	52,36 x 39,27
	1/2" (6,4 x 4,8):	69,82 x 52,36
	1/1.8" (7,13 x 5,37):	77,76 x 58,56
	2/3" (8,8 x 6,6):	96,00 x 72,00
<b>Working Distance (mm):</b>	279,6 +/- 8	
<b>Working F-number:</b>	8	
<b>MTF @70 lp/mm (%):</b>	> 40	
<b>Field Depth (mm):</b>	70,0 @	F/ 8
<b>Image side N.A.:</b>	0,062	
<b>Object side N.A.:</b>	0,006	
<b>Telecentricity (degree):</b>	<0,08	
<b>Distortion (%):</b>	<0,08	
<b>Mount:</b>	C	
<b>Length (mm):</b>	338	
<b>Maximum external diameter (mm):</b>	146	
<b>Weigh (g):</b>	3100	

## NOTES:

- 1) The inner aperture diaphragm can be supplied on request with smaller apertures in order to achieve a larger Field Depth
- 2) Tailored diffusive Ring Light available on request
- 3) Custom flanges and mechanical interfaces can be provided on request
- 4) Can be coupled to a collimated light illuminator like LT CL 96

Rev No.	Description	Date	Name
A	First light	01/05/03	A.Vismara
D	Redesign	15/02/06	A.Vismara

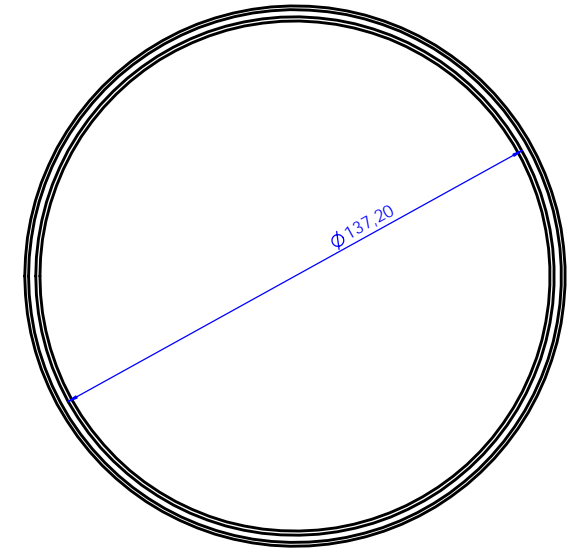
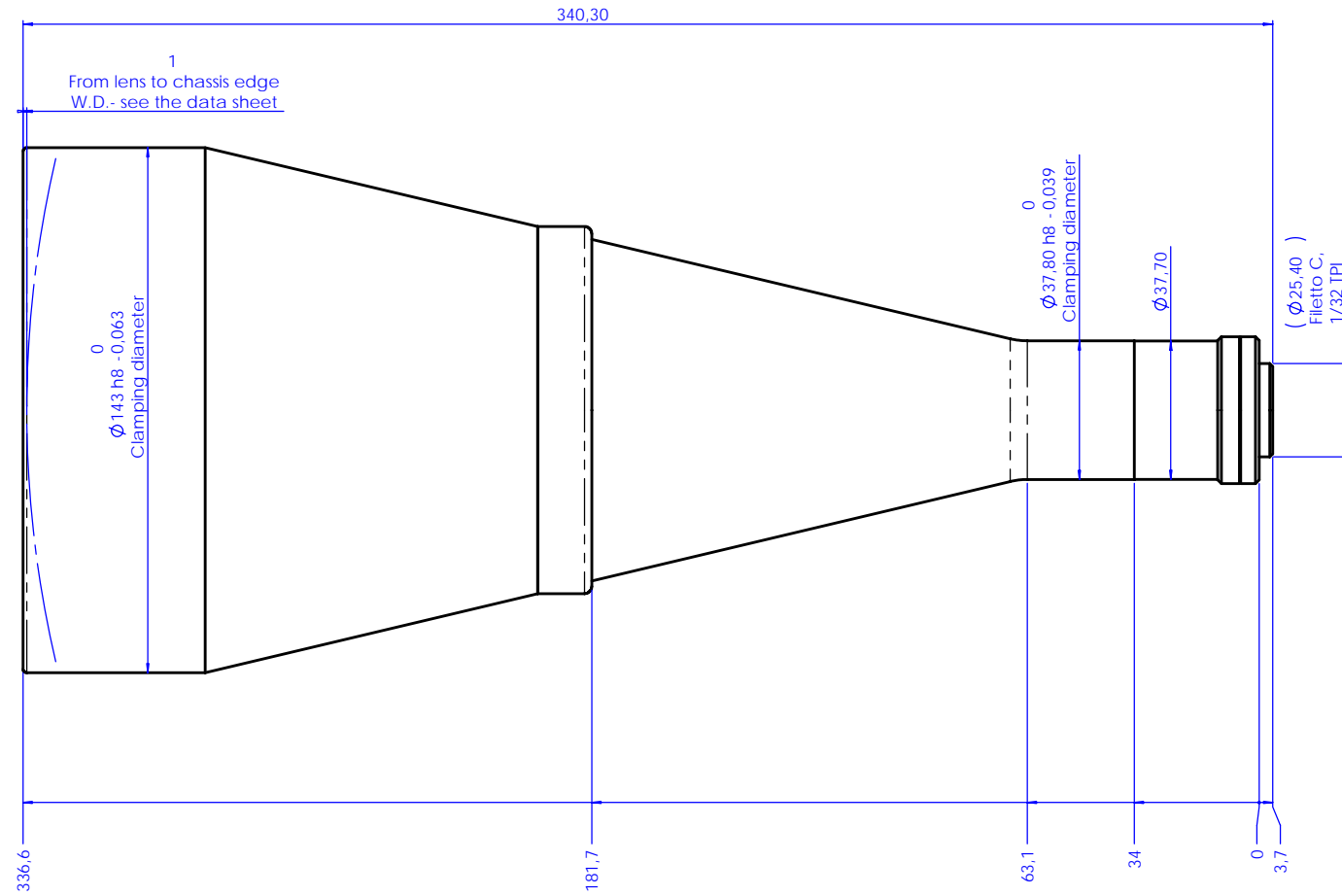

Material	N.A.	Mass	2.5 kg	Scale	1:1
Surface treatment	N.A.	Project-Prod.Item/Instrument Telecentric lens 23 96			
Geometrical tolerance (ISO 2768-2)		Class	K	Undimensioned Bevels	1x45°
Linear tolerance (ISO 2768-2)		Class	m	Undimensioned radii	R 0.5
0.5	>3-	>6-	>30-	>120-	>400-
>3	6	30	120	400	1000
±0.1	±0.1	±0.2	±0.3	±0.5	±0.8
					±1.2
www.opto-engineering.com		Date	Name		
Designed		15/02/06	A.Vismara		
Draw		15/02/06	A.Vismara		
Checked		x	C.Sedazzari		
Drawing No.		02201-0-D			
Sheet		1/1			
Reproduction forbidden without specific authorization					
OPTO ENGINEERING S.r.l. - 46100 Mantova Italy - Via Cremona, 28 - Tel/fax +39 0376 229585 - e-mail info@opto-engineering.com - http://www.opto-engineering.com					