

BI-TELECENTRIC LENS FOR 2/3" TO 1/4" DETECTORS



WWW.OPTO-ENGINEERING.COM



Model:	TC 23 80		
Magnification (X):	0,11		
Object Field (mm):	1/4" (3,6 x 2,7):	32,73	x 24,55
	1/3" (4,8 x 3,6):	43,64	x 32,73
	1/2" (6,4 x 4,8):	58,18	x 43,64
	1/1.8" (7,13 x 5,37):	64,80	x 48,80
	2/3" (8,8 x 6,6):	80,00	x 60,00
Working Distance (mm):	227,7 +/- 7		
Working F-number:	8		
MTF @70 lp/mm (%):	>50		
Field Depth (mm):	57,0 @ F/ 8		
Image side N.A.:	0,062		
Object side N.A.:	0,007		
Telecentricity (degree):	<0,08		
Distortion (%):	<0,1		
Mount:	C		
Length (mm):	272		
Maximum external diameter (mm):	120		
Weigh (g):	1530		

NOTES:

- 1) The inner aperture diaphragm can be supplied on request with smaller apertures in order to achieve a larger Field Depth
- 2) Tailored diffusive Ring Light available on request
- 3) Custom flanges and mechanical interfaces can be provided on request
- 4) Can be coupled to a collimated light illuminator like LT CL 80

Rev No.	Description	Date	Name
A	First light	10/03/06	A.Vismara

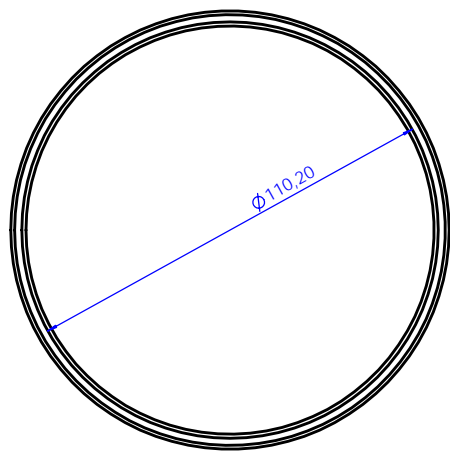
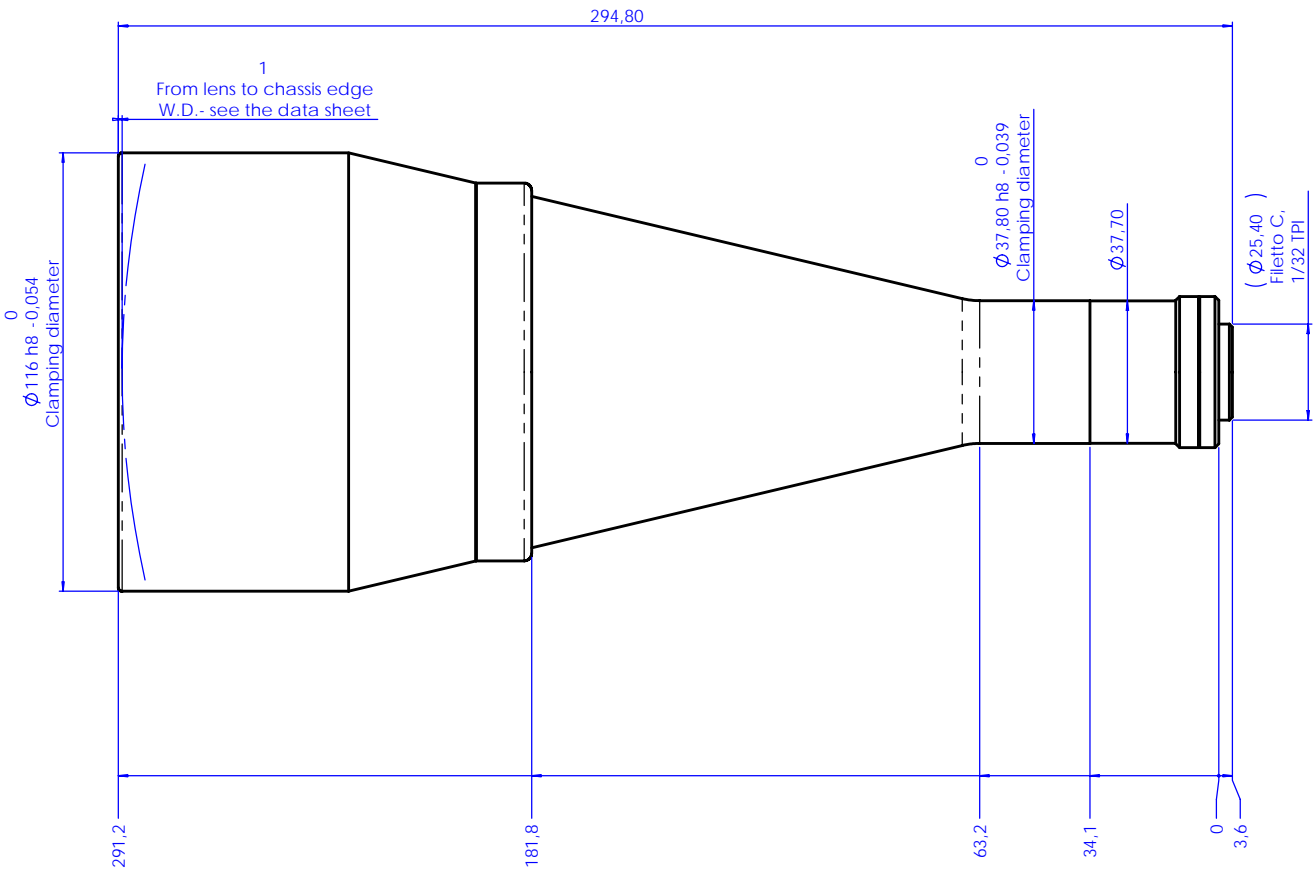

Material	N.A.	Mass	1.6 kg	Scale	1:1
Surface treatment	N.A.	Project-Prod.Item/Instrument		Telecentric lens 23 80	
Geometrical tolerance (ISO 2768-2)		Class	K	Undimensioned Bevels	1x45°
Linear tolerance (ISO 2768-2)		Class	m	Undimensioned Radii	R 0.5
0.5	>3-	>6-	>30-	>120	>400-
-3	-6	-30	-120	-400	-1000
+0.1	+0.1	+0.2	+0.3	+0.5	+0.8
					+1.2
Date		Name		Drawing No.	
Designed 10/03/06		A.Vismara		02401-0-A	
Draw 10/03/06		A.Vismara		Sheet	
Checked x		C.Sedazzari		1/1	
OPTO ENGINEERING S.r.l. - 46100 Mantova Italy - Via Cremona, 28 - Tel/fax +39 0376 229585 - e-mail info@opto-engineering.com - http://www.opto-engineering.com					