

BI-TELECENTRIC LENS FOR 2/3" TO 1/4" DETECTORS



WWW.OPTO-ENGINEERING.COM



Model:	TC 23 120		
Magnification (X):	0,07		
Object Field (mm):	1/4" (3,6 x 2,7):	49,09	x 36,82
	1/3" (4,8 x 3,6):	65,46	x 49,09
	1/2" (6,4 x 4,8):	87,28	x 65,46
	1/1.8" (7,13 x 5,37):	97,20	x 73,20
	2/3" (8,8 x 6,6):	120,01	x 90,00
Working Distance (mm):	336,5 +/- 10		
Working F-number:	8		
MTF @70 lp/mm (%):	>35		
Field Depth (mm):	105,0	@	F/ 8
Image side N.A.:	0,062		
Object side N.A.:	0,004		
Telecentricity (degree):	<0,08		
Distortion (%):	<0,1		
Mount:	C		
Length (mm):	422		
Maximum external diameter (mm):	185		
Weigh (g):	3800		

NOTES:

- 1) The inner aperture diaphragm can be supplied on request with smaller apertures in order to achieve a larger Field Depth
- 2) Tailored diffusive Ring Light available on request
- 3) Custom flanges and mechanical interfaces can be provided on request
- 4) Can be coupled to a collimated light illuminator like LT CL 120

Rev No.	Description	Date	Name
A	First light	14/04/06	A.Vismara

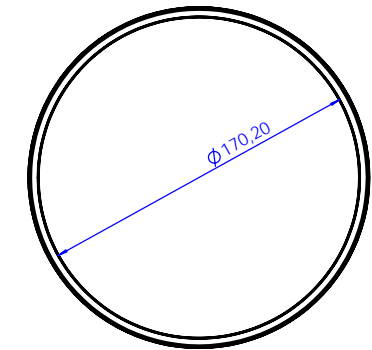
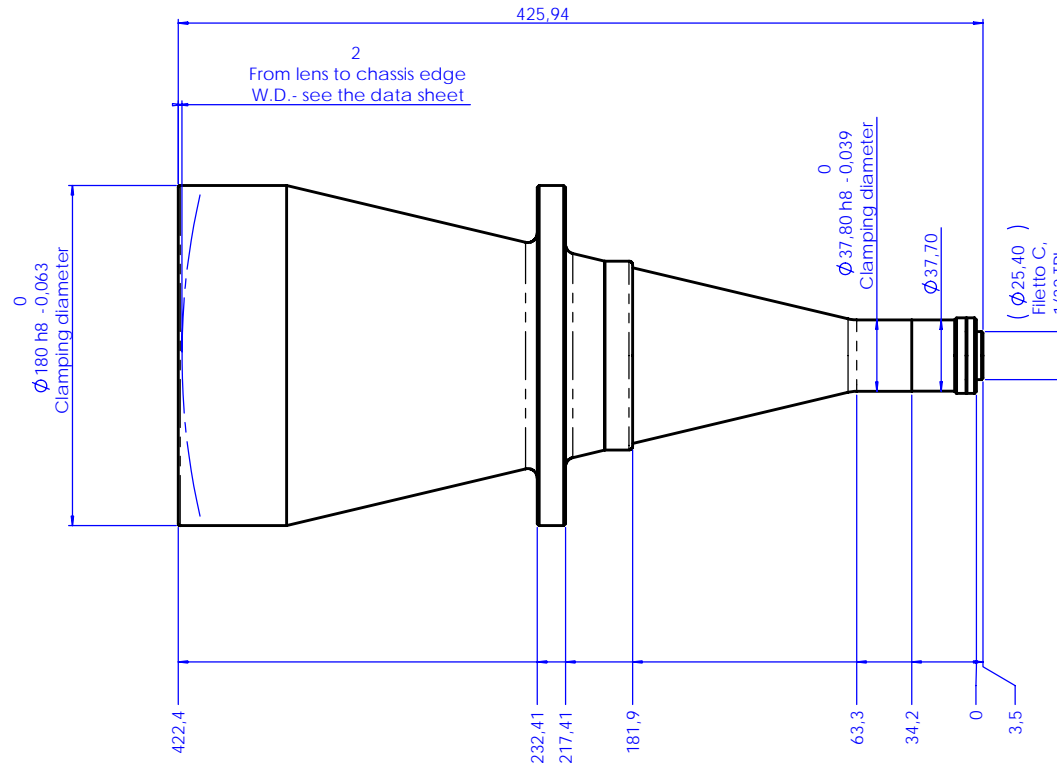
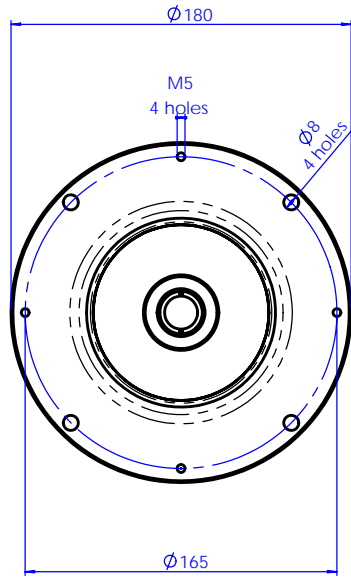

Material	N.A.	Mass	5.3 kg	Scale	1:2
Surface treatment	N.A.	Project-Prod.Item/Instrument	Telecentric lens 23 120		
Geometrical tolerances (ISO 2768-2)		Class	K	Undimensioned Bevels	1x45°
Linear tolerance (ISO 2768-2)		Class	m	Undimensioned radii	R 0.5
0.5	>3-	>6-	>30-	>120	>400-
-3	6	30	120	400	1000
±0.1	±0.1	±0.2	±0.3	±0.5	±0.8
					±1.2
Date		Name		Drawing No.	
Designed 14/04/06		A.Vismara		02501-0-A	
Draw 14/04/06		A.Vismara		Sheet 1/1	
Checked x		C.Sedazzari		Reproduction forbidden without specific authorization	
OPTO ENGINEERING S.r.l. - 46100 Mantova Italy - Via Cremona, 28 - Tel/Fax +39 0376 229585 - e-mail info@opto-engineering.com - http://www.opto-engineering.com					