

BI-TELECENTRIC LENS FOR 2/3" TO 1/4" DETECTORS



WWW.OPTO-ENGINEERING.COM



Model:	TC 23 110		
Magnification (X):	0,08		
Object Field (mm):	1/4" (3,6 x 2,7):	45,00	x 33,75
	1/3" (4,8 x 3,6):	60,00	x 45,00
	1/2" (6,4 x 4,8):	80,00	x 60,00
	1/1.8" (7,13 x 5,37):	89,10	x 67,10
	2/3" (8,8 x 6,6):	110,00	x 82,50
Working Distance (mm):	336,5 +/- 10		
Working F-number:	8		
MTF @70 lp/mm (%):	> 40		
Field Depth (mm):	90,0	@	F/ 8
Image side N.A.:	0,062		
Object side N.A.:	0,005		
Telecentricity (degree):	<0,08		
Distortion (%):	<0,07		
Mount:	C		
Length (mm):	431		
Maximum external diameter (mm):	185		
Weigh (g):	3600		

NOTES:

- 1) The inner aperture diaphragm can be supplied on request with smaller apertures in order to achieve a larger Field Depth
- 2) Tailored diffusive Ring Light available on request
- 3) Custom flanges and mechanical interfaces can be provided on request
- 4) Can be coupled to a collimated light illuminator like LT CL 120

Rev No.	Description	Date	Name
A	First light	15/06/06	A.Vismara

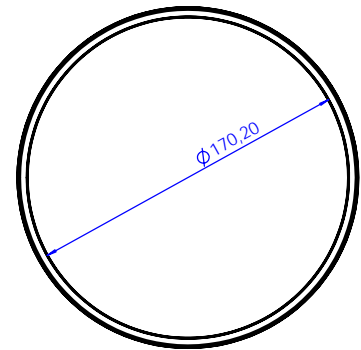
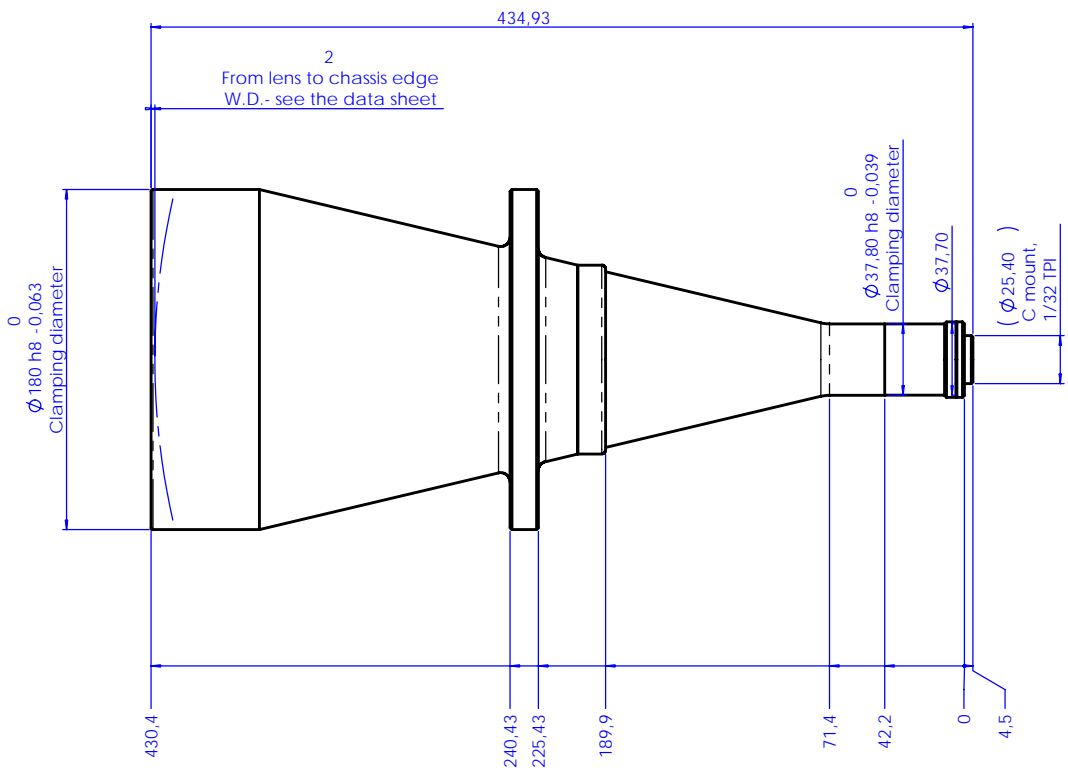
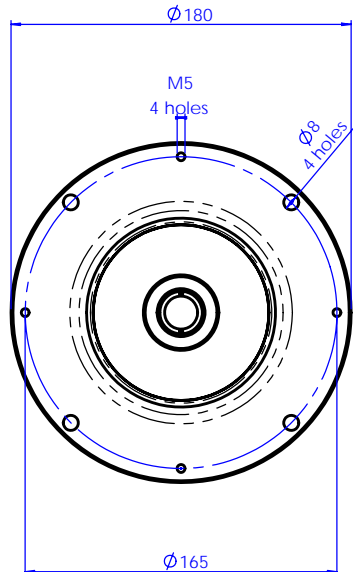

Material	N.A.	Mass	5.3 kg	Scale	1:2
Surface treatment	N.A.	Project-Prod.Item/Instrument	Telecentric lens 23 110		
Geometrical tolerance (ISO 2768-2)		Class	K	Undimensioned Bevels	1x45°
Linear tolerance (ISO 2768-2)		Class	m	Undimensioned Radii	R 0.5
0.5	>3-	>6-	>30-	>120	>400-
-3	6	30	120	400	1000
±0.1	±0.1	±0.2	±0.3	±0.5	±0.8
		Class	m	±1.2	±2
www.opto-engineering.com		Date	Name		
Designed		15/06/06	A.Vismara		
Draw		15/06/06	A.Vismara		
Checked		x	C.Sedazzari		
Drawing No.		02251-0-A			
Sheet		1/1			
Reproduction forbidden without specific authorization					
OPTO ENGINEERING S.r.l. - 46100 Mantova Italy - Via Cremona, 28 - Tel/Fax +39 0376 229585 - e-mail: info@opto-engineering.com - http://www.opto-engineering.com					