

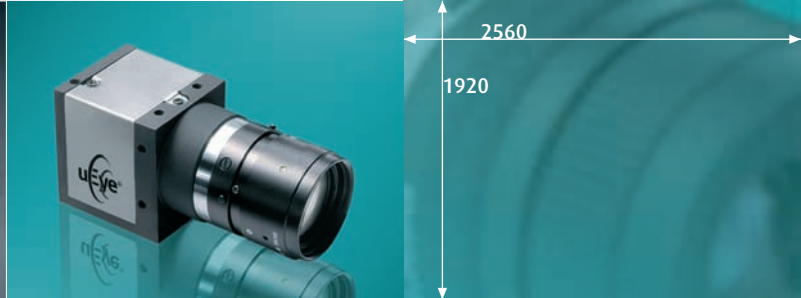

**iDS**



**uEye<sup>®</sup> UI-1480-C/M**

**5 Mega pixels QSXGA Camera with 1/2" CMOS Sensor**

# uEye® UI-1480-C/M



## The uEye® Family

uEye® stands for a family of extremely compact, low-cost cameras for professional use in automation, quality assurance, security technology and non-industrial applications. Through the use of the widespread USB technology, the cameras can be interfaced with a vast variety of systems without any problems.

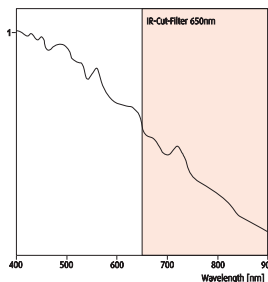

Sensor characteristics

UI-1480-M

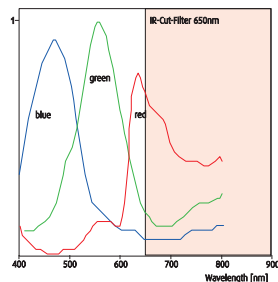

UI-1480-C

Screw-mounted Micro Sub-D connector for USB, Trigger and Digital-Out

Conventional USB Mini-B connector

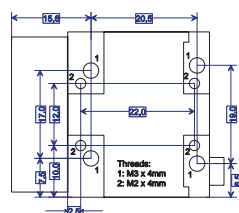
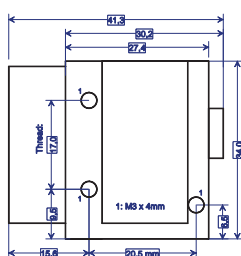
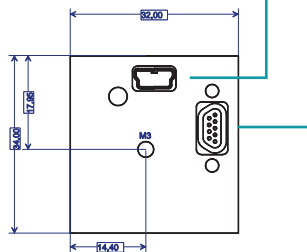
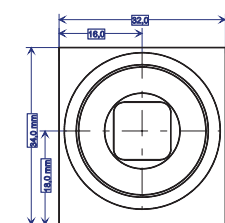

## The characteristics at a glance

Interface	USB 2.0
Sensor Technology	CMOS
Model description (color)	UI-1480-C
Model description (Mono)	UI-1480-M
Resolution (h x v)	2560 x 1920
Resolution Category / Pixel Class	QXSGA/5 MP
Sensor size	1/2"
Shutter	Rolling/Global Start
max. fps in Freerun Mode at full resolution	6,3 fps
max. fps in SW Trigger Mode at 1 ms exposure	6,1 fps
Exposuretime in Freerun Mode	75 µs - 2745 ms
Exposuretime in Trigger Mode	75 µs - 2745 ms
AOI Modes	H <sup>2</sup> + V <sup>2</sup>
AOI with 320 x 240 Pixels (CIF)	126 fps
Subsampling Modes	H <sup>2</sup> + V <sup>2</sup>
Subsampling Factors	x2, x4
Resolution, fps	1280 x 960, 25 fps 640 x 480, 100 fps
Binning Modes	H <sup>2</sup> + V <sup>2</sup>
Binning Method	H: Sum V: Average
Binning Factors	x2, x4
Resolution, fps	1280 x 960, 19 fps 640 x 480, 43 fps
Mono: Maximum Gain	30x
Color: Maximum Gain RGB/Master	6,5x/12x
Additional Gain Boost with Factor	1,6x
Sensor Model	MT9P031
Pixel Clock	5 - 43/95 MHz
Pixelpitch in µm	2,2
Full Well Capacity	12.000 e-
Optical Size	5,63 x 4,22 mm
Aspect Ratio	4:3
Exact Real Diagonal	7,0 mm, 1/2,3"
Current consumption at 5 V	90 - 130 mA

<sup>2</sup> = Use increases frame rate

### In scope of delivery:

Powerful, easy to handle uEye SDK  
uEye Demo and Programexamples  
executable and Source Code.  
TWAIN, Active-X and Direct Show  
(WDM) drivers  
Interfaces for Activision Tools,  
Common Vision Blox, HALCON,  
LabVIEW and Neurocheck

Driver for Windows 2000, XP, VISTA  
and Linux - WindowsCE on request

